

CEMA Safety Labels Placement Guidelines

Product: Pneumatic Conveyors

Equipment: Rotary Valves (PN-1)

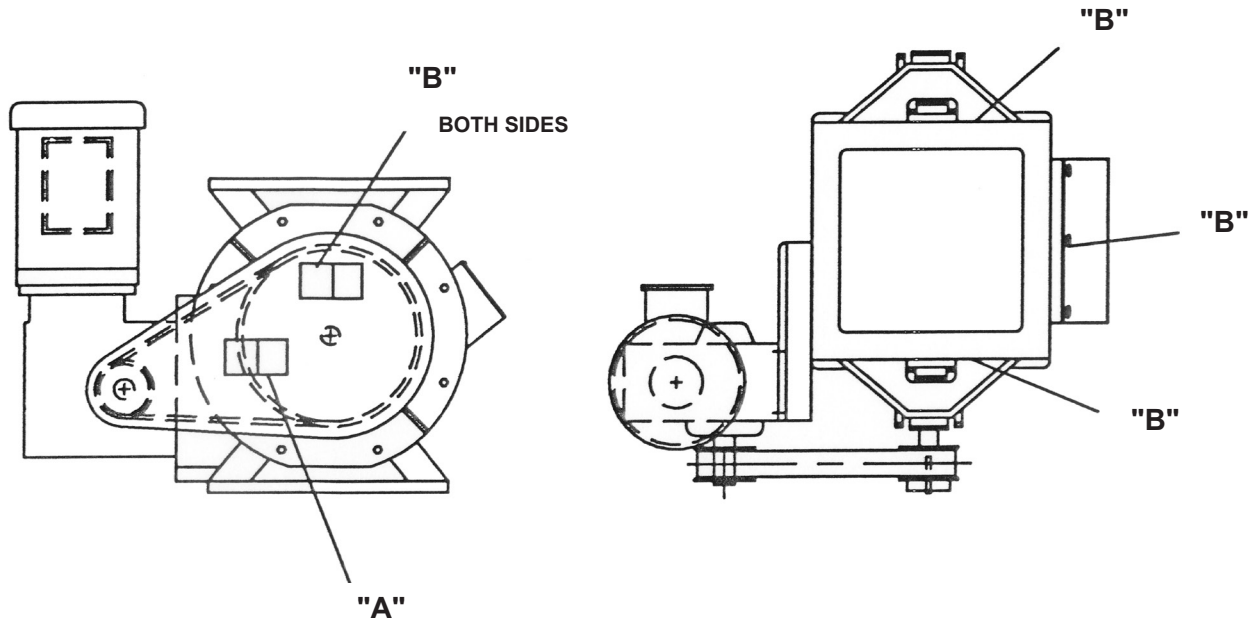

"A"

(LOCATED ON BELT/CHAIN GUARD)
To be placed on removable guards to warn that operation of the machinery with guards removed would expose chains, belts, gears, shafts, pulleys, couplings, etc. which create hazards.

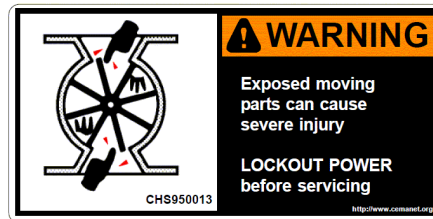

"B"

(LOCATE ON INSPECTION PORT AND AT BOTH ENDS OF HOUSING)
To be placed on rotary valves and delumpers to warn that the equipment's exposed moving parts create hazards to be avoided by locking out the equipment prior to servicing.